

Hand Blender

User Manual

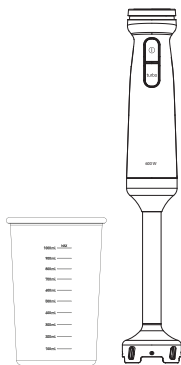

HBS7600W

EN | DE | FR | TR | ES | PL | IT | RO

01M-8839623200-1919 -03

beko

CONTENTS

ENGLISH	8-14
---------	------

DEUTSCH	15-24
---------	-------

FRANÇAIS	25-33
----------	-------

TÜRKÇE	34-41
--------	-------

ESPAÑOL	42-52
---------	-------

POLSKI	53-62
--------	-------

ITALIANO	63-73
----------	-------

ROMÂNĂ	74-84
--------	-------

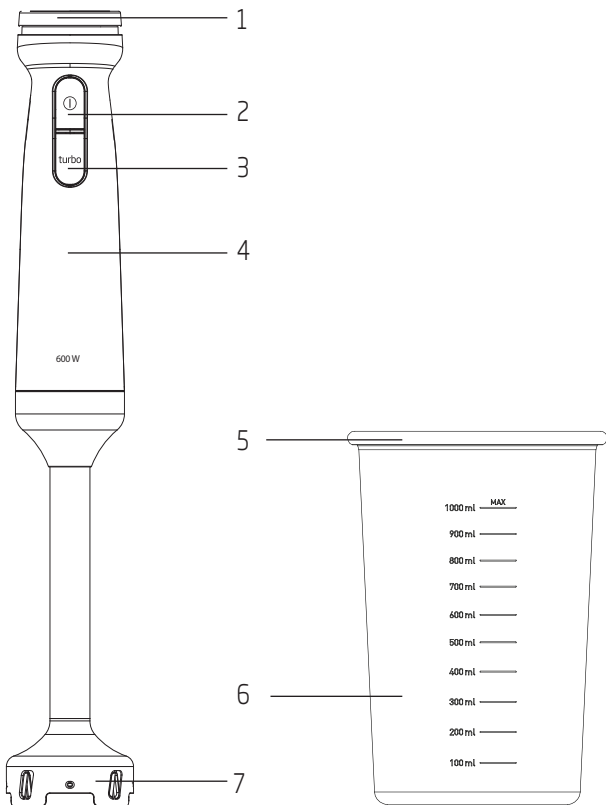

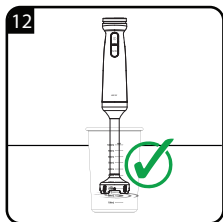
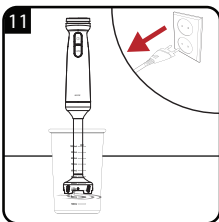
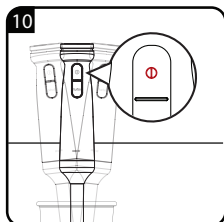
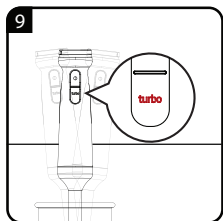
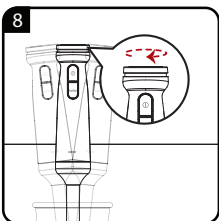
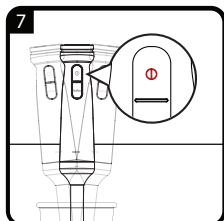
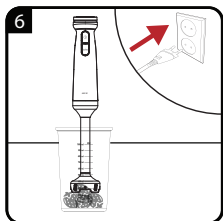
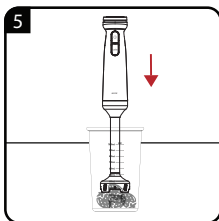
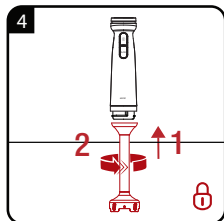
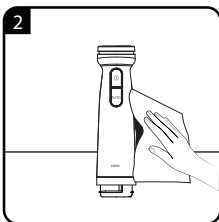
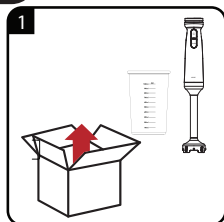

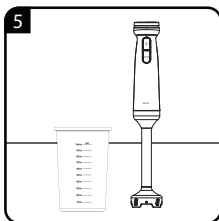
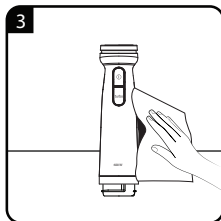
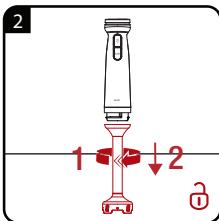
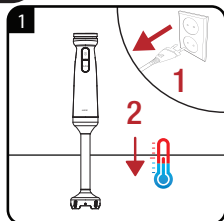

EN	OPERATION	CLEANING AND CARE
DE	BETRIEB	REINIGUNG UND PFLEGE
FR	FONCTIONNEMENT	NETTOYAGE ET ENTRETIEN
TR	KULLANIM	TEMIZLEME VE BAKIM
ES	FUNCIONAMIENTO	LIMPIEZA Y CUIDADOS
PL	OBSŁUGA	CZYSZCZENIE I KONSERWACJA
IT	UTILIZZO	PULIZIA E CURA
RO	UTILIZARE	CURĂ AREA ȘI ÎNGRIJIREA
AR	التشغيل	التنظيف والعناية

Please read this manual first!

Dear Valued Customer,

Thank you for preferring this Beko appliance. We hope that you get the best results from your appliance which has been manufactured with high quality and state-of-the-art technology. For this reason, please read this user manual and all other provided documents carefully before using the appliance and keep it as a reference for future use. If you hand over the appliance to someone else, give the user manual as well. Follow the instructions by paying attention to all the information and warnings in the user manual.

Meanings of the symbols

Following symbols are used in various sections of this manual:



Important information and useful hints about usage.



WARNING: Warnings for dangerous situations concerning the safety of life and property.



Suitable for contact with food.



Do not immerse the appliance in water.



Protection class for electric shock.



This product has been produced in environmentally-friendly, state-of-the-art facilities.

Conforms to the WEEE Directive.



It does not contain PCB.

1. Speed adjustment button
2. Operating switch
3. Turbo button
4. Motor unit
5. Non-slip rubber base (cover)
6. Measuring beaker
7. Blending shaft

Technical data

Power supply:

220-240 V ~, 50-60 Hz

Power: 600 W

Rights to make technical and design changes are reserved.

1 Important safety and environmental instructions

This section contains safety instructions that will help protect from risk of personal injury or material damage. Failure to follow these instructions voids any granted warranty.

1.1 General safety

- This appliance complies with international safety standards.
- This appliance can be used by people who have limited physical, sensory or mental capacity or who do not have knowledge and experience, provided that they are supervised or they understand the instructions with regard to safe use of the product and potential dangers. Children should not play with the appliance. Cleaning and maintenance works should not be performed by children.
- This appliance cannot be used by children.
- Keep the appliance and the power cable out of the reach of children.

1 Important safety and environmental instructions

- Do not use it if the power cable, blades or the appliance itself is damaged. Contact an authorised service.
- Only use the original parts or parts recommended by the manufacturer.
- Do not attempt to dismantle the appliance.
- Your mains power supply should comply with the information supplied on the rating plate of the appliance.
- Do not use the appliance with an extension cable.
- Do not pull the power cable when unplugging the appliance.
- Unplug the appliance when left unattended and wait for it to stop completely while installing/removing accessories or before cleaning.
- Do not touch the plug of the appliance with damp or wet hands.
- Do not use the device for hot food.
- Use the appliance only with the supplied base and container.

1 Important safety and environmental instructions

- Do not operate the appliance without the ingredients in the bowl.
- Remove bones and stones from food to prevent the blades and the appliance from getting damaged.
- This appliance is not suitable for dry or hard foods as this will quickly cause the blades to become dull.
- Follow all warnings to prevent injuries due to incorrect use.
- When emptying the container, during cleaning and grabbing chopping blades with bare hands serious injuries could result due to incorrect use. Use the plastic section trying to hold the chopping blade.
- After cleaning, dry the appliance and all parts before connecting it to mains supply and before attaching the parts.
- Do not immerse the appliance, power cable, or power plug in water or any other liquids.
- Do not operate or place any part of this appliance or its parts on or near hot surfaces.
- If you keep the packaging materials, store them out of the reach of children.

1 Important safety and environmental instructions

1.2 Compliance with the WEEE Directive and Disposing of the Waste Product:

This product complies with EU WEEE Directive (2012/19/EU). This product bears a classification symbol for waste electrical and electronic equipment (WEEE).



This symbol indicates that this product shall not be disposed with other household wastes at the end of its service life. Used device must be returned to official collection point for recycling of electrical and electronic devices. To find these collection systems please contact to your local authorities or retailer where the product was purchased. Each household performs important role in recovering and recycling of old appliance. Appropriate disposal of used appliance helps prevent potential negative consequences for the environment and human health.

1.3 Compliance with RoHS Directive

The product you have purchased complies with EU RoHS Directive (2011/65/EU). It does not contain harmful and prohibited materials specified in the Directive.

1.4 Package information



Packaging materials of the product are manufactured from recyclable materials in accordance with our National Environment Regulations. Do not dispose of the packaging materials together with the domestic or other wastes. Take them to the packaging material collection points designated by the local authorities.

1 Important safety and environmental instructions

1.5 Things to do for energy saving

Follow the times recommended in the manual during use. Unplug the appliance after use.

2 Usage

2.1 Intended use

This appliance is intended only for household use; it is not suitable for professional use. It is designed for chopping and whisking small amounts of solid food only.

2.2 Maximum quantities

Ingredient	Max. amount
Garlic/Onions (diced)	150-250 g
Soup	200-300 g
Parsley	40-50 g
Meat (diced)	100-150 g
Cheese (diced)	100-150 g
Hazelnut/Almond Kernels	100-200 g
Fruit (diced)	250-300 g
Infant formula	250-300 g



- Each press on the operating switch that lasts 1 to 2 seconds is a "PULSE".
- Pressing the operating switch for 1 second is enough for soft foods like onions and parsley.
- Turn speed adjustment button (1) to gradually increase speed.
- Start mixing in low speed while mixing ingredients. Ingredients may be spattered when you start with high speed.

3 Cleaning and care

3.1 Cleaning and care



WARNINGS:

- Do not touch the blades with your bare hands.
- Do not wash the blending shaft in dishwasher.
- Never immerse inner part of blending shaft, the motor unit or power cable in water or in any other liquid.
- Never use gasoline, solvent, abrasive cleaning agents, metal objects or hard brushes to clean the appliance.

3.2 Storage

- If you do not intend to use the appliance for a long time, store it carefully.
- Unplug the appliance before lifting the appliance and its cable.
- Store the appliance in a cool and dry place.
- Keep the appliance out of the reach of children.

3.3 Handling and transportation

- During handling and transportation, carry the appliance in its original packaging. The packaging of the appliance protects it against physical damages.
- Do not place heavy loads on the appliance or on the packaging. The appliance may get damaged.
- Dropping the appliance may render it non-operational or cause permanent damage.